

Profili in alluminio Sistemi di apertura vetri per banchi e vetrine

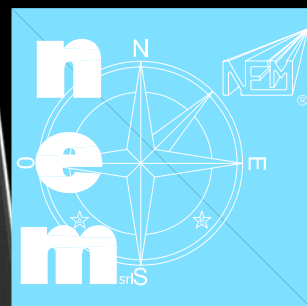

● Sistema 150

1. Sistema per l'apertura a traslazione di vetri piani e curvi da 6mm
2. Completo di accessori per la realizzazione di angoli sferici e cilindrici, "aperti" e "chiusi"
3. Possibilità di installare montantini anteriori di allineamento del vetro
4. Possibilità di dotare i banchi di una chiusura a scatto che ne impedisca l'apertura accidentale
5. Il ridotto impatto estetico, ma l'alta qualità e tecnologia, lo rendono un prodotto unico nel suo genere e molto apprezzato
6. Ideale per banchi macelleria, pescherie, gastronomie, autonegozi, piccoli negozi alimentari e per la grande distribuzione

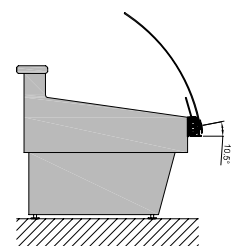
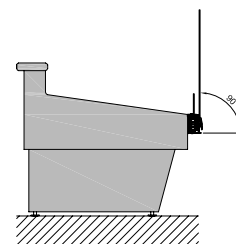

nem srl

Via Redipuglia, 16 Z.I.
34070 San Pier d'Isonzo (GO) - Italy
Tel: +39 0481 70297
Fax: +39 0481 70275
Email: nem@nemsrl.it
Web: <http://www.nemsrl.it>



nemsrl.it

Sistema 150

Sistema per l'apertura a traslazione di vetri da 6mm

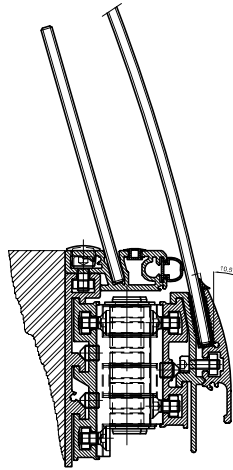
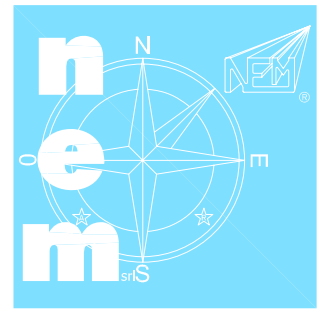

**Vetro inclinato
10.5° - R1016**

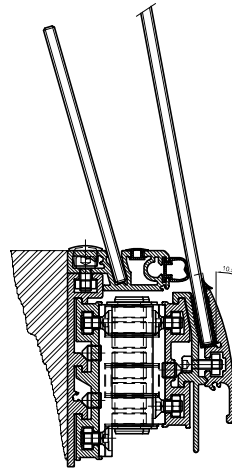

**Vetro piano
inclinato 10.5°**

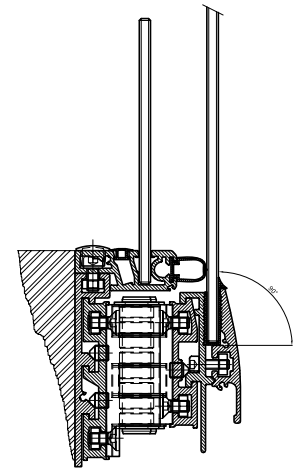

**Vetro piano
verticale 0°**

COMPONENTI PRINCIPALI

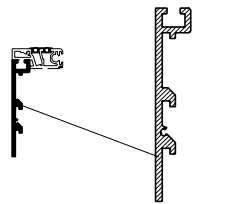

Profilo base portante

L=5000mm Cod. 150.7210

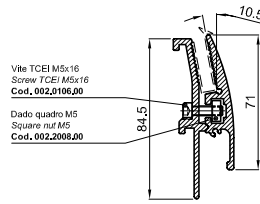

Profilo maniglia 10.5° completa L=5000mm Cod. 150.7650

10.5°

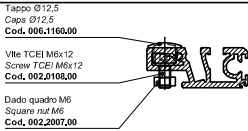

Profilo carter superiore (viti escl.) L=5000mm Cod. 150.7750

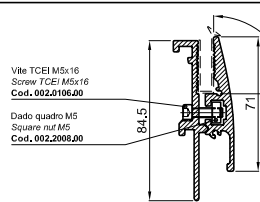

Profilo maniglia 0° completa L=5000mm Cod. 150.8050

0°

Meccaniche di apertura complete

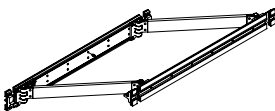

A lunghezza maniglia	B apertura	Cod.
900 ± 1014mm (36" ± 40")	≈ 545mm	Cod. 150.3100.00
1015 ± 1214mm (41" ± 47")	≈ 635mm	Cod. 150.3200.00
1215 ± 1414mm (48" ± 55")	≈ 820mm	Cod. 150.3300.00
1415 ± 1560mm (56" ± 61")	≈ 1000mm	Cod. 150.3400.00

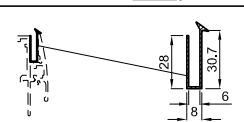

Guarnizione maniglia L=100m Cod. 075.0099.03

COMPONENTI OPZIONALI

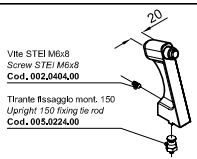

Kit montantino anteriore (vetro curvo)

Cod. 150.0039

10.5°

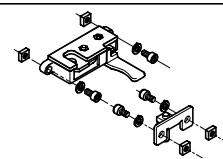

Kit completo serratura e perno Cod. 150.0067.00

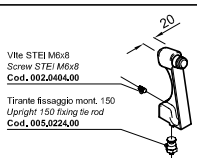

Kit montantino anteriore (vetro piano 10.5°)

Cod. 150.0035

10.5°

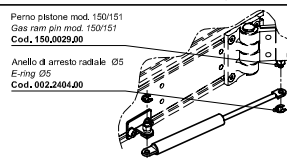

Kit compl. molla a gas per linea con supporto
150N Cod. 150.0150.00
200N Cod. 150.0200.00

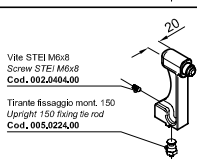

Kit montantino anteriore (vetro dritto)

Cod. 150.0037

0°

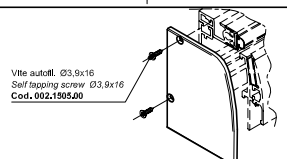

Tappe chiusura lat. compl. di viti Dx/Rt Sx/Lt* Cod. 150.1803
Cod. 150.1804

* Rappresentato particolare Sx



nem srl

Via Redipuglia, 16 Z.I.
34070 San Pier d'Isonzo (GO) - Italy
Tel: +39 0481 70297
Fax: +39 0481 70275
Email: nem@nemsrl.it
Web: http://www.nemsrl.it



nemsrl.it