

Aluminium profiles Glass opening systems for counters and display cabinets

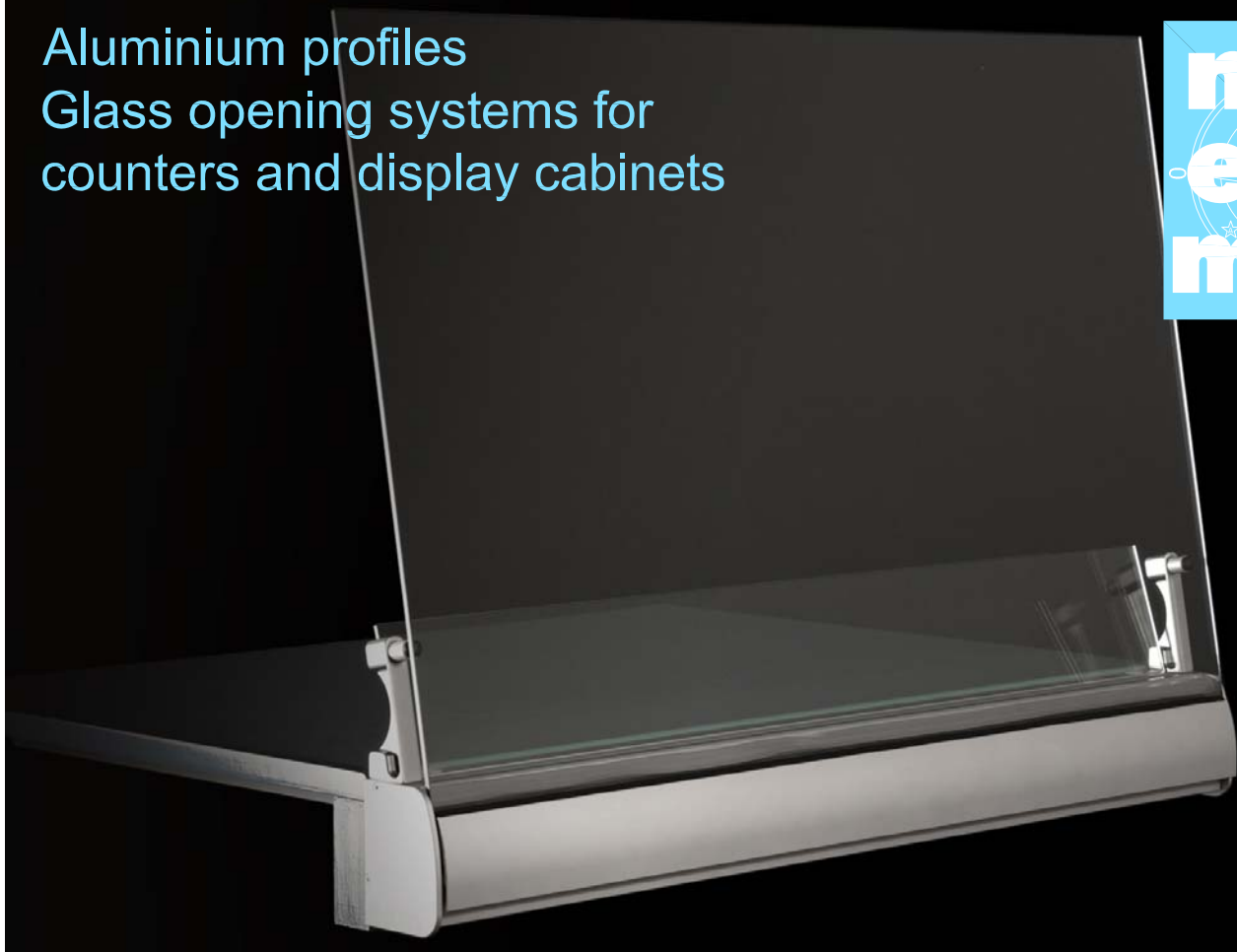

• System 150

1. Swing-out opening system for flat, curved and spherical glass, thickness 6mm
2. Accessorized for spherical, cylindrical both open as closed corners
3. Front uprights for glass alignment available
4. Counters can be equipped with a locking system that will avoid any accidental openings
5. The minimum esthetic impact and its high quality and technological features make this product the leader in its category and it is very appreciated by a wide range of Customers
6. Good solution for butcher's shop, seafood, deli, traveling shops, small environments and big distribution

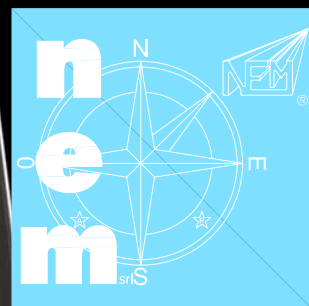
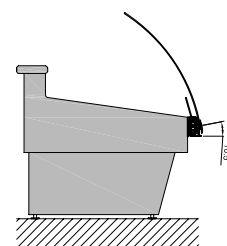
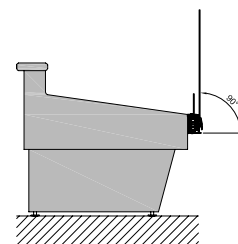

nem srl

Via Redipuglia, 16 Z.I.
34070 San Pier d'Isonzo (GO) - Italy
Tel: +39 0481 70297
Fax: +39 0481 70275
Email: nem@nemsrl.it
Web: <http://www.nemsrl.it>



nemsrl.it

System 150

Swing-out opening system for flat, curved and spherical glass, thickness 6mm

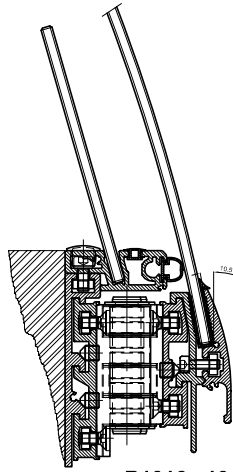
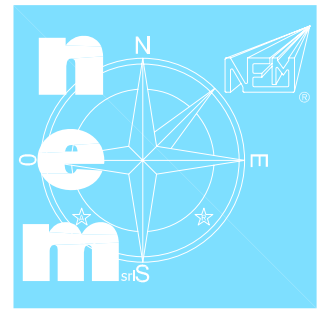

R1016 - 10.5° angle glass

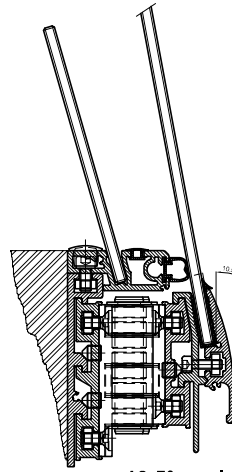

10.5° angle flat glass

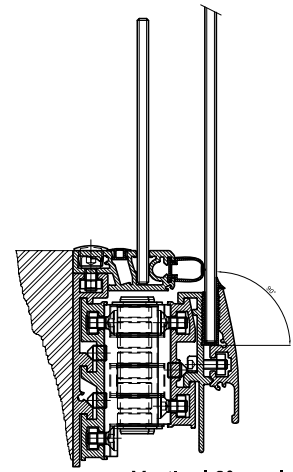

Vertical 0° angle flat glass

MAIN COMPONENTS

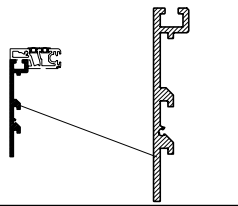

Load bearing base profile L=5000mm Cod. 150.7210

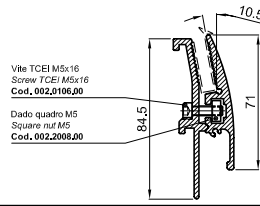

10.5°
Complete hand grip 10.5° L=5000mm Cod. 150.7650

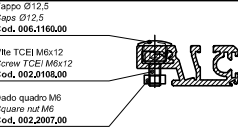

Top cover profile (w/o screws) L=5000mm Cod. 150.7750

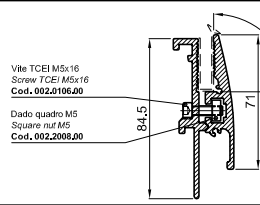

0°
Complete hand grip 0° L=5000mm Cod. 150.8050

Complete opening devices

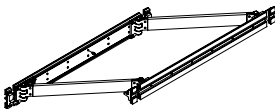

A hand grip size	B opening	Cod.
900 ÷ 1014mm (36" ÷ 40")	≈ 545mm	Cod. 150.3100.00
1015 ÷ 1214mm (41" ÷ 47")	≈ 635mm	Cod. 150.3200.00
1215 ÷ 1414mm (48" ÷ 55")	≈ 820mm	Cod. 150.3300.00
1415 ÷ 1560mm (56" ÷ 61")	≈ 1000mm	Cod. 150.3400.00

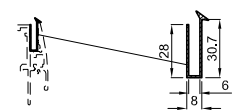

Hand grip gasket L=100m Cod. 075.0099.03

OPTIONAL COMPONENTS

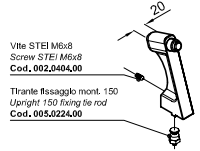

10.5°
Kit front upright (curved glass) Cod. 150.0039

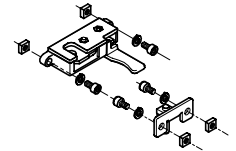

Lock and pin complete kit with screws Cod. 150.0067.00

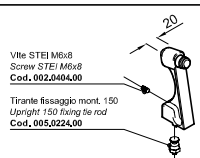

10.5°
Kit front upright (10.5° strike glass) Cod. 150.0035

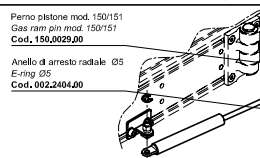

Gas spring for linear case complete kit
150N Cod. 150.0150.00
200N Cod. 150.0200.00

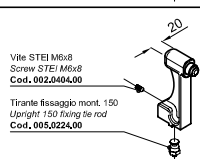

0°
Kit front upright (strike vertical glass) Cod. 150.0037

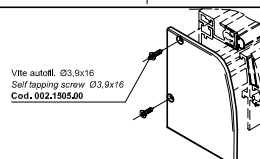

Complete end cap with screws Dx/Rt Sx/Lt* Cod. 150.1803 Cod. 150.1804

* Left part represented



nem srl

Via Redipuglia, 16 Z.I.
34070 San Pier d'Isonzo (GO) - Italy
Tel: +39 0481 70297
Fax: +39 0481 70275
Email: nem@nemsrl.it
Web: http://www.nemsrl.it



nemsrl.it